

PLEASE NOTE THAT A DONATION WILL BE PLACED IN THE CUSTODY OF THE LOCAL PARISH COUNCIL TO ALLOW FOR THE PROVISION OF A BUS STOP TO THE NORTH SIDE OF HARWICH ROAD, OR AT ANOTHER LOCATION IN THE VILLAGE TO BE AGREED WITH THE LOCAL PARISH COUNCIL AS PART OF THE PROPOSED INFRASTRUCTURE SCHEME.

PLEASE NOTE THAT THE DEVELOPER IS TO CONSTRUCT A NEW BUS STOP AND SHELTER & 2M WIDE FOOTPATH ON LAND OWNED BY ECC HIGHWAYS IN A POSITION CLEAR OF THE HARWICH ROAD AND FRATING ROAD JUNCTION'S VISIBILITY SPLAY, ALL ENTIRELY AT THE DEVELOPERS EXPENSE IN ORDER LINK THE SITE TO THE LOCAL PUBLIC TRANSPORT SYSTEM - (SEE DETAILS).

2.4 METRE X 120 METRE VISIBILITY SPLAY FROM JUNCTION.

HARWICH ROAD (40 mph)

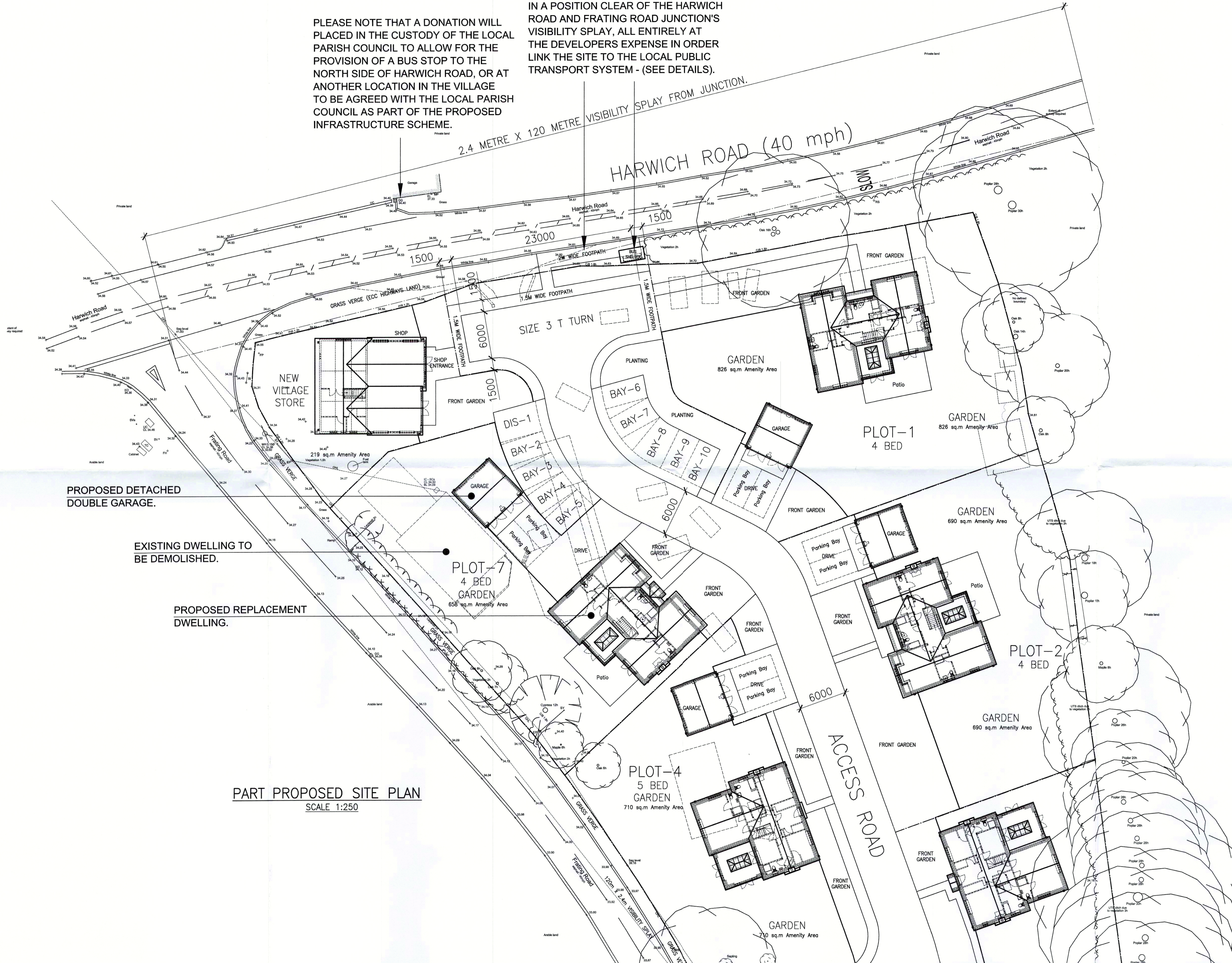

PROPOSED DETACHED DOUBLE GARAGE.

EXISTING DWELLING TO BE DEMOLISHED.

PROPOSED REPLACEMENT DWELLING.

PART PROPOSED SITE PLAN  
SCALE 1:250

Contract  
PROPOSED REPLACEMENT DWELLING AT "LITTLE PADDOCKS", FRATING ROAD, GREAT BROMLEY, ESSEX. C07 7JL.

Title  
PART PROPOSED SITE PLAN.

Client  
MR & MRS M. O'BRIEN.

REV	DATE	DESCRIPTION
P	02/19	PRELIMINARY-ISSUED FOR PLANNING APPROVAL.

**Stour Valley Design**  
Planning & Building Design Service  
Swan Corner, Mill Lane, Bradfield, Essex. C011 2UT  
Telephone Numbers: (01255) 870352, Mobile: (07739) 328066  
email address: simontankard@btinternet.com  
website address: www.stour-valley-design.co.uk

Scale 1:250.  
Date FEBRUARY 2019.  
Drawn S. TANKARD

Drawing No.  
15-2019-02<sup>P</sup>